

If you could provide a bed for a survivor knowing that it could save a life, would you do it?



Helpmate

Domestic Violence Advocacy

New Emergency Shelter Campaign:
Strengthening the Heart of Our Community

SAVING LIVES

Strengthening the Heart of Our Community

April 2024

There is an unmistakable correlation between domestic violence shelter space and domestic violence-related homicides. The vast majority (96%) of domestic violence murder victims in the United States did not work with a program like Helpmate in the year before they died. This underscores the importance of the shelter and support services offered by Helpmate. 91% of survivors who reside in Helpmate's current shelter fall into the "extreme risk" category on the Danger Assessment, which measures homicide risk.

Coming together to provide essential emergency shelter and safety for survivors and their children



Helpmate

Domestic Violence Advocacy

New Emergency Shelter Campaign:
Strengthening the Heart of Our Community



Today we do not have enough space to provide emergency shelter for the adult and child survivors of domestic abuse in our community who need it. This is why we intend to build a new shelter with 43 beds—more than double the current capacity—which will enable us to meet projected needs for our community. The Dogwood Health Trust, the City of Asheville, Buncombe County, Jerry and Marlene Sternberg, the North Carolina Housing Finance Agency, The Leon Levine Foundation, and the NC Human Trafficking Commission have made early generous funding commitments that enabled the project to move forward with confidence.

The 23,000 square foot safe and secure building we envision will provide 25 efficiency suites of varying sizes that can accommodate individuals or up to three members of a family. Shared spaces will include indoor and outdoor play/learning spaces for children, kitchens, a dining area, and a support group meeting room.

Thank you to these funders for their generous Lead Funding commitments.



Jerry and Marlene Sternberg provided a generous challenge gift of \$1 million.

Dear Friends,

For every night of safety and shelter we provide for survivors and their children—and we provided more than 5,000 nights over the past year alone—we are preventing further violence and saving lives. Another 300 families call Helpmate seeking shelter when all beds are full.

The new shelter will provide greater flexibility so that we can shelter more survivors and their children in lodging that meets the unique needs of families. By increasing the number of bedrooms to 25 and offering various configurations of sleeping areas, we will be able to shelter at least twice as many victims and their children each year.

Now, when our shelter is full, Helpmate works with survivors to find safe shelter, often in a nearby county. *That means that Buncombe County, the largest and most resourced community in WNC, is exporting trauma to our rural neighbors on a near daily basis.* Families are often faced with difficult decisions to leave jobs, schools, and other supports, just to find a safe place to stay.

There is an alternative. And our community is coming together to create it.

Now is the time to answer: **Yes.**

We will provide the essential safety, shelter, and support that victims of domestic violence need in their most vulnerable and dangerous moments of crisis.

We will create the opening they need to break the cycle of domestic violence.

Your answer, your investment, and our collective commitment will make this vision a reality.



Sincerely,

April Burgess-Johnson
Executive Director

Strengthening the heart of our community



Domestic violence, also known as intimate partner violence, is a persistent issue in Buncombe County. It is present in every neighborhood, and across all boundaries of income, race and education. The trends are not encouraging. In the past two years the number of criminal cases involving domestic violence rose from 837 to 1171, a nearly 40% increase. Over a similar time period, the number of in-depth Danger Assessments Helpmate conducted increased from 850 to more than 1200.

Nothing is more important to the heart of a community than having children and families living in secure homes that are free from violence.

For more than 45 years, Helpmate has provided free, confidential, life-saving services to victims of domestic violence and their children.

For victims and children at greatest risk, being able to access safe and secure shelter can be, literally, the difference between living and dying.

Helpmate is poised to take a giant leap forward toward protecting the heart of our community by expanding the **safe, emergency shelter** that is urgently needed to save and support victims of domestic violence.



Beyond the safety of the shelter, Helpmate offers a full range of survivor services, including:

- **24/7 Hotline:** Immediate crisis intervention, danger assessment, and safety planning
- **Case Management:** Support with practical needs such as childcare, transportation, and employment
- **Housing Support:** Assistance finding, affording and keeping safe housing, including rental assistance funding
- **Children's Services:** Advocacy with Child Protective Services, and Juvenile/Family Courts to help keep children safe and interrupt the inter-generational cycle of violence
- **Counseling:** Group and individual therapeutic counseling in a trauma-informed setting to address emotional and behavioral impacts of trauma exposure
- **Court Advocacy:** Support to navigate the civil and criminal justice systems to increase survivor safety
- **Survivor Engagement:** Offers opportunities for survivors who are beyond their immediate crisis to inform organizational, community and statewide initiatives to promote positive change
- **Survivor Outreach:** Teaches educational workshops focused on available help and resources to people at highest risk of domestic violence victimization, including college students, pregnant women, and people in substance use recovery
- **Prevention Education:** Works with schools, employers, businesses, faith groups, and community organizations to reduce the rates of perpetration of domestic violence
- **Systems Change Advocacy:** Partners with allied professionals to create a unified service system that prioritizes survivor needs and minimizes barriers to help-seeking

A survivor speaks

“ I also want people to know that Helpmate likely saved my life as I was in extreme danger. They helped me understand what happened to me, and provided guidance to navigate the system. Mostly, they provided comfort and support, and the knowledge that I am not alone in this. I'm not the only woman who has trusted and been abused, threatened, and hurt by someone they were in love with. I am so grateful for Helpmate as I move forward with a new life with my child. ”

Shared vision and collaboration

*Domestic violence is a complex issue that requires a coordinated response. Having provided direct support to thousands of victims over 45 years, Helpmate has unique insights into their needs and the ways in which community organizations can work together to address them. In 2013, Helpmate was a leader in a process that brought together Buncombe County and collaborating partners overhaul response systems and to form the **Buncombe County Family Justice Center**, a nationally recognized best practice model where survivors are able to come to a single location and have multiple needs met in one visit. There we collaborate to provide essential crisis services for survivors including advocates, child welfare, childcare, medical services, legal aid, law enforcement and prosecution. **By coming together, we have strengthened our ability to respond to domestic violence, reduce assaults and homicides, and improve survivor experiences.***

Much collaborative work has gone into the process to inform the building and program design for the new shelter, engage essential partners, and secure current funding commitments of over \$11,900,000.

Over the past eight years Helpmate has evaluated expanding our current shelter and has reviewed other potential properties and locations. We are grateful to Partners in Mercy, LLC for their generous donation of land adjacent to Helpmate's current shelter. The benefits of this location include being on the bus line and close to medical, legal, and other support services that are essential for victims of domestic violence.

We are grateful that The Family Justice Center model is working as intended, with more victims learning about help they can access from Helpmate and greater collaboration across many agencies and partners. Since the opening of the FJC in 2016, referrals to Helpmate's shelter have nearly doubled.

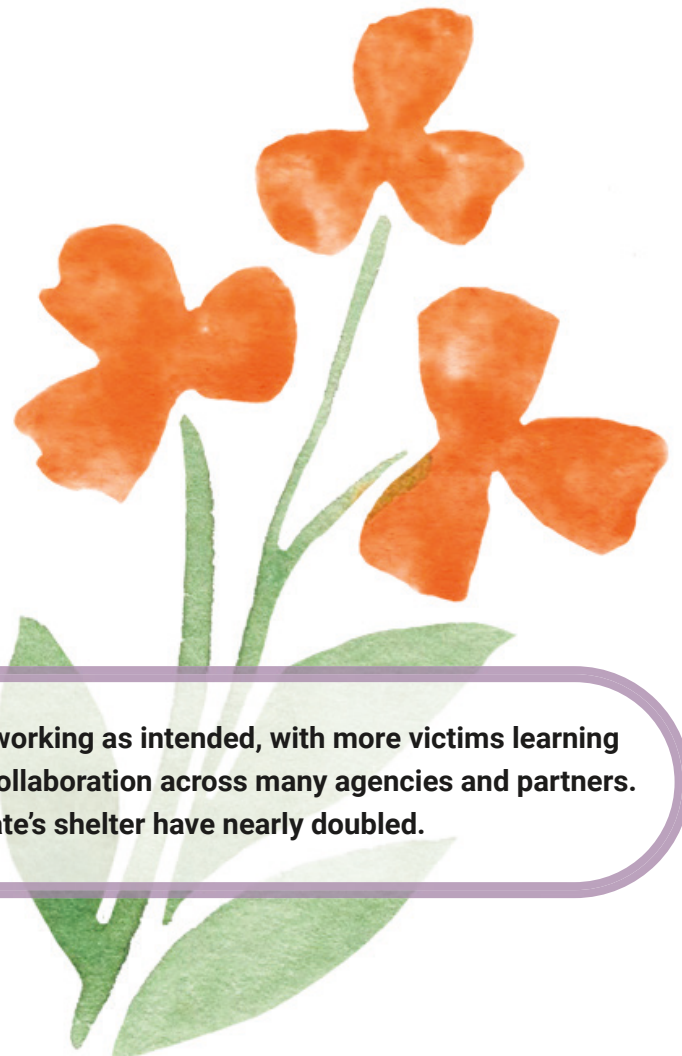

It is clear that more emergency shelter space is needed to protect survivors and children in crisis in our community. **On a per capita basis, Buncombe County has the second highest rate in North Carolina of domestic violence survivors who need shelter in their home community, but who are not able to find it.** This is due to the limited capacity of the current Helpmate shelter.

The design for the shelter is based on best practices and has been developed with input from collaborating partners and expert advisors.

BUILDING AND DESIGN TEAM:

Advanced Energy Consultants

Aiken Cost Consultants

Beverly-Grant Construction

Brooks Engineering Associates

Carleton Collins Architecture

Mathews Architecture

McAbee and Associates

Medlock and Associates Engineering

Player Consulting

Siteworks Studios

SUD and Associates

WNC Technologies

WSP Environment and Infrastructure



Carleton Collins
ARCHITECTURE
Thoughtful · Community · Design

CAMPAIGN LEADERSHIP:

Donna Ensley, Campaign Chair

Duane Adams

Lauren Karlsson

Michelle Kostelich

Fran Paschall

Ginny Raviotta

Bonnie Spradling

John Stewart

Don Swaby

The impact of the new 23,000 square foot shelter

- Increase available emergency shelter from 20 to 43 beds.
- Create a pandemic-responsive layout, incorporating efficiency/pod-style units to afford opportunities for social distancing and greater privacy for healing.
- Provide shared spaces including indoor and outdoor children's play spaces, a support group meeting room, a dining area, and a lounge and library space.
- Configure multiple small kitchens versus a large commercial kitchen, which allows families to prepare meals on their own without competing for limited space. Laundry facilities will be on each floor.
- Enhance security features to ensure safety of survivors and staff including a fire suppression system, high-definition cameras, and a reinforced safe room equipped with steel doors.
- Have staff offices on site to ensure round-the-clock support to survivors and a dedicated counseling center to provide trauma-informed care.
- All bedrooms will be accessible for people with disabilities and for those recuperating from abuse-related injuries that impair mobility.
- Offer a shelter market where residents can easily obtain free toiletries, diapers, and other essentials.
- Expand and provide more comprehensive services to adults and children.



Strengthening the heart of our community

HELPMATE NEW SHELTER FINANCIAL INFORMATION

Overall, the project cost is \$15.375 million. This includes a \$1 million operating reserve to enable the shelter to increase staffing so that we may provide holistic services for shelter residents. To date, nearly \$11.9 million has been secured from grants and generous donors. An additional \$1.475 million is anticipated from the potential sale of the existing shelter and from pending grants. \$2 million is needed to complete the project.

“The (shelter) staff goes beyond the normal to help. They really care for each person. All are given the same help, and it is up to each of us to do the work. I did the work and now tomorrow I will be moving into my apartment. Thank you, Helpmate!”

– Former Helpmate Client

LEVEL 2 LIFE SAFETY PLAN
3/2" = 1'-0"

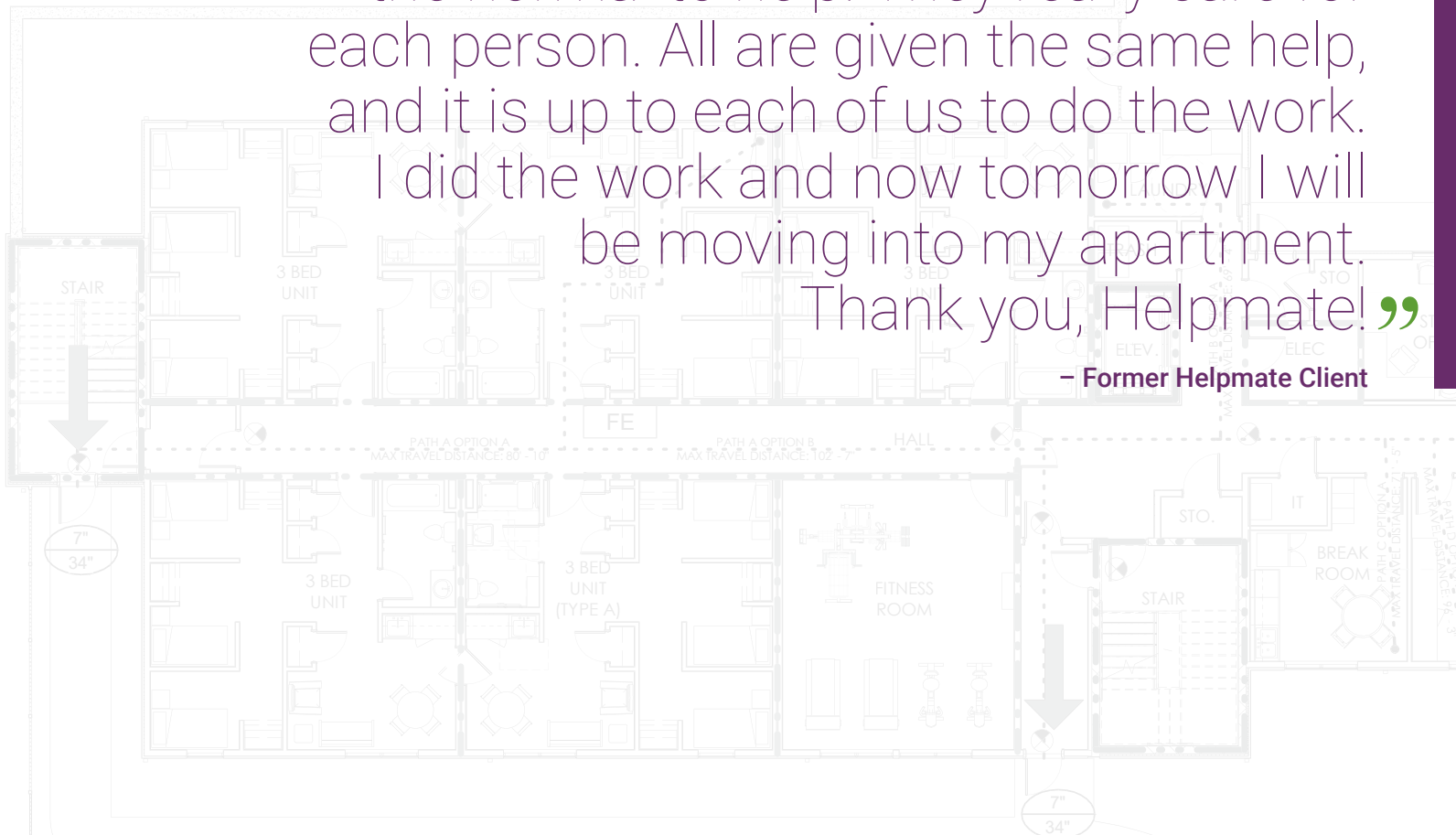

HELPMATE CAPITAL EXPENSE BUDGET

| | |
|--|---------------------|
| Design, Architectural and Engineering | \$ 960,000 |
| Site Preparation and Infrastructure ¹ | \$ 3,200,000 |
| Building Construction and Security | \$ 9,105,000 |
| Furnishings and Appliances | \$ 200,000 |
| Contingency, Financing, and Administration | \$ 910,000 |
| Operational Funding | \$ 1,000,000 |
| Total | \$15,375,000 |

¹ Land Purchase Price \$150,000 (value \$1.6M)

HELPMATE EMERGENCY SHELTER FUNDING SECURED AND ANTICIPATED

Funding Secured

| | |
|-----------------------------------|--------------|
| Grants Received | \$ 8,900,000 |
| Community Contributions Committed | \$ 3,000,000 |

Anticipated Funding

| | |
|--------------------------------|--------------|
| Grants Pending | \$ 100,000 |
| Community Contributions Needed | \$ 2,000,000 |

Campaign Milestone

| | |
|---|--------------|
| Potential Sale of Current Facility or Other Funding (net) | \$ 1,375,000 |
|---|--------------|

Total

| | |
|--------------|---------------------|
| Total | \$15,375,000 |
|--------------|---------------------|

TABLE OF INVESTMENTS: COMMUNITY GOAL

| | Gift Amount | # Gifts Needed | Subtotal |
|------------------------|-------------|----------------|---------------------|
| Lead Gifts | \$ 500,000 | 1 | \$ 500,000 |
| | \$ 150,000 | 1 | \$ 150,000 |
| | \$ 100,000 | 2 | \$ 200,000 |
| Major Gifts | \$ 50,000 | 6 | \$ 300,000 |
| | \$ 25,000 | 16 | \$ 400,000 |
| Mid-Level & | \$ 10,000 | 24 | \$ 240,000 |
| Public Phase | \$ 5,000 | 30 | \$ 150,000 |
| | <\$5,000 | 70 | \$ 60,000 |
| Total | | 150 | \$ 2,000,000 |



Lead Funding Partners:

Dogwood Health Trust
 City of Asheville
 Buncombe County
 Jerry and Marlene Sternberg
 NC Housing Finance Agency
 The Leon Levine Foundation
 NC Human Trafficking Commission

Helpmate Shelter Expansion Campaign Goal:

\$15,375,000

Balance to Raise

Community Contributions \$2M
 Potential Sale of Existing Shelter \$1.375M

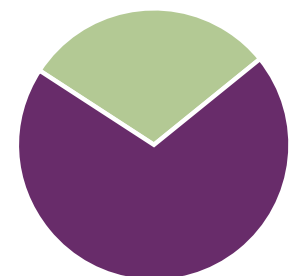

↑ Generous Commitments Received/Pending
\$12M

Helpmate services lead to action and increased safety

16,253

emergency safety plans were formed by domestic violence survivors working with Helpmate in one year.

40%

more survivors worked with court advocates to address criminal domestic violence this year than pre-pandemic.

30

30 is the average Danger Assessment score for survivors served by Helpmate, indicating extreme risk for homicide. The maximum score is 36.

92%

of survivors served by Helpmate improve their individual safety strategies.

HELPMATE TOTAL INDIVIDUAL SERVICE CONTACTS

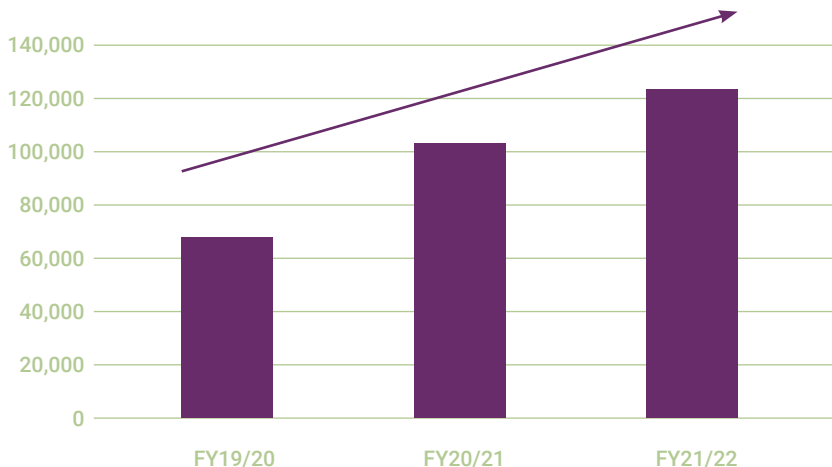

Over the past three years, the number of survivors Helpmate has served increased by about 9%. Even more significant is the depth of need among survivors. The contacts of services and support that Helpmate has provided to survivors have increased 55% over the past three years.

A message from Jerry Sternberg

As the smallest kid in my junior high school, I was constantly bullied by the larger and older kids. From these experiences I have some minimal understanding of the shame, pain, fear and terrible humiliation suffered by victims of domestic violence.

Escaping from these circumstances is extremely difficult and can be life threatening. Abusers quite often isolate their victims from family and social interaction with friends, even forcing them to quit their jobs, leaving them no safe options for help and escape.

Helpmate was created by caring members of the community to provide a firewall for these traumatized victims. It enables them to access essential services provided with the guidance of the incredible dedicated staff serving their clients such as legal and medical referral, psychological counselling, employment opportunities and, most of all, lifesaving protection.

Helpmate has offered emergency shelter for 45 years under the most difficult of circumstances particularly during the Covid-19 pandemic. Our community has experienced a burgeoning population growth and the case load has grown exponentially, especially with the additional plagues of increased alcohol and drug abuse.

We have long outgrown our shelter and it is time for the community to invest in a new, expanded facility. Marlene and I were pleased to be part of this worthy endeavor. We are grateful that our challenge gift of \$1 million helped inspire others in the community to invest in this project to save lives.

We must remember that domestic abuse does not spare anyone because of financial or social circumstances, and it can be lethal.

By contributing to this new facility, you will truly be giving the gift of life. And an opportunity for survivors to start over in a new life and, more important, a safe and secure life.

Sincerely,



Jerry Sternberg

One life lost is one too many

More than 9 out of every 10 survivors who came to our shelter over the past year were evaluated as being at extreme risk of homicide.* Others who were also in extreme danger had to be referred to shelter and safety elsewhere, or be temporarily housed in a hotel.

It will take the engagement of our entire community to strengthen our response to domestic violence. With adequate support, survivors can break the cycle of violence for themselves, their children, and the generations that follow.

If you could provide a bed for a survivor knowing that it could save a life, would you do it?

Please consider the most generous financial investment you can make to support the success of this essential expansion of emergency shelter space for survivors and children in our community.

*Based on an evidence-based tool Helpmate uses that was developed by Johns Hopkins University to assess homicide risk.





“ Helpmate is proud to offer so many services to survivors of intimate partner violence in our community, from counseling to shelter to court advocacy to housing. Such wrap-around support is crucial to our mission. But of these services, our emergency shelter is the most critical, as it provides a literal lifeline to people escaping violence. The shelter saves lives. Our goal is to provide services that match the needs of our community, and our new shelter is one of the most important resources that we can provide to protect our neighbors who are at greatest risk of immediate harm. With your support, the Board and staff of Helpmate can meet this critical need in our community. We thank you for joining us and our other generous supporters in investing in making Buncombe County safer for everyone. ”



– Board Chair Elect **R. Graham Reynolds, Ph.D.**

Domestic violence impacts everyone

33% **OF WOMEN**

10% **OF MEN**

50% **OF TRANSGENDER PEOPLE**

HAVE OR WILL EXPERIENCE INTIMATE PARTNER VIOLENCE

The CDC estimates that nearly 60,000 in Buncombe County will experience domestic violence in their lifetimes. Domestic violence impacts people of all genders, all races, all socio-economic classes, and all backgrounds. Helpmate is here for all survivors.

We all
have a
basic
human
right to
safety

Helpmate works with our community to eliminate abuse and fear by providing safety, shelter, and support for victims and survivors of intimate partner violence. We are the only provider of crisis services in Buncombe County.

We offer an emergency shelter plus a host of supportive services, including counseling, case management, court advocacy, 24/7 crisis line response and prevention education. Serving 3600 survivors annually, Helpmate is the largest domestic violence service provider in WNC and serves 29% more survivors per capita than the statewide average.

Helpmate's services comply with the Violence Against Women Act, the Family Violence Prevention and Services Act, and are designed based on the Best Practices Manual for Domestic Violence Programs in NC to ensure safety and promote healing.

Helpmate Board of Directors

Duane Adams:

Associate Director
Small Business Center
and Business Incubation,
Asheville-Buncombe Technical
Community College

Jennifer Adams:

Senior Wealth Advisor
Mercer Advisors

Beverly Brignolo, Secretary:

Co-Founder
DWR Audio

Mariate Echeverry:

Senior Transportation Planner
AECOM

Chuck Farlow:

General Manager
Hampton Inn & Suites by Hilton

Belinda Grant:

Executive Director
Mt. Zion Community Development

Joyce Greene:

Vice-President
Hour Glass Cleaners

Cindy Holman:

Retired
Attorney

Frederick Hudson:

Law Enforcement Coordinator
US DOJ, Western District of NC

Peter Kanipe:

Attorney
McGuire, Wood and Bissette

Lauren Karlsson:

Community Volunteer

Joni Lisenbee, Treasurer:

Market Director
HCA Healthcare NC

Fran Paschall, Vice-Treasurer:

Retired
Healthcare Professional

Ginny Raviotta, Chair:

Retired
Mission Health

Graham Reynolds, Chair Elect:

Associate Professor, Biology
UNC-Asheville

Ceil Sanow:

Community Volunteer

Gary Snipes:

Director of Sales
Jabil Healthcare

Bonnie Spradling, Immediate Past Chair:

Retired
Non-profit Executive

Lucy Wheeler:

Director of Post-Acute Operations
CarePartners

HELPMATE

PO Box 2263
Asheville, NC 28802
www.helpmateonline.org

For more information, contact:
Pam King, Development Director
pking@helpmateonline.org
(828) 254-2968 ext. 145

